

<b>Model</b>	ADF for F11 (Ricoh DF52)	<b>Volt/Hz</b>	<b>Date of Modification</b>	<b>Serial Number</b>
<b>Modified Article</b>	Left Hinge			
<b>Reason for Modification</b>	To ensure the DF up and down operation			

Draw No.	Old Parts No.	New Parts No.	Description	A.B.C.	Q'ty Used Old → New	Inter- change- ability	Part needed for replacement by new part		Parts Catalog	
				Rank			Part No.	Description	Index No.	Page
	A4221394	A4221393	Left Hinge		1 - 1	x/o			4	7

Rank: A : Replace with new parts immediately.      B : Replace with new parts at time of repair.      C : Replace with new parts at time of overhaul.

Interchangeability:

(1) When old and new parts are not mutually interchangeable, use additional parts or an assembly part as indicated in "Parts needed for replacement by new part" to install the new part.

(2) The mark to the left of the slash indicates whether the old part can be used in the new machine, and the mark to the right indicates whether the new part can be used in the old machine.    x = Not interchangeable    o = Interchangeable

**DETAILS OF MODIFICATION**

When the operator opens the DF, it may open too fast after it reaches approximately 30 degrees as shown in the illustration.

To prevent this, tension of the springs in the DF left hinge has been changed. The new left hinge will not let the DF open too fast even after it reaches approximately 60 degrees.

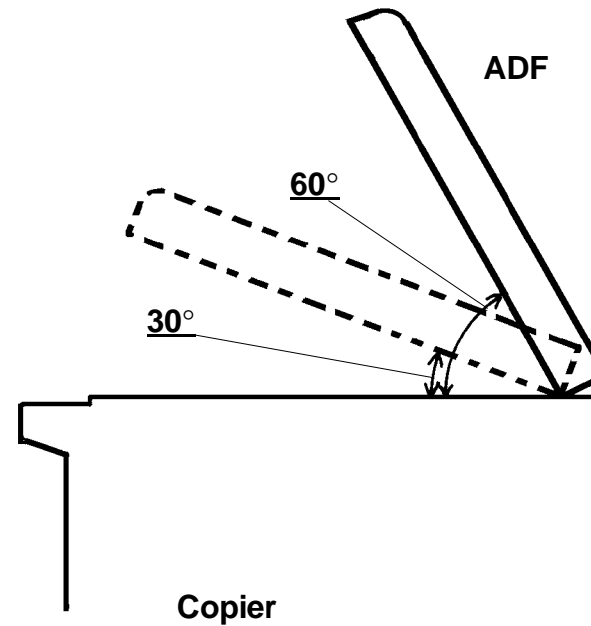

MODEL NAME	V/Hz	DESTINATION	CODE	SERIAL NUMBER
Ricoh DF52	115/60	USA, Canada	A422-17	2330100001
Ricoh DF52	220,240/50	Europe, etc.	A422-27	2330100101

<b>Model</b>	ARDF for F11 (Ricoh DF52)	<b>Volt/Hz</b>	<b>Date of Modification</b>	<b>Serial Number</b>
<b>Modified Article</b>	Front Frame			
<b>Reason for Modification</b>	Parts standardization with ARDF for N230			

Due to parts standardization with the ARDF for the N230, the front frame has been changed with the interchangeability code O/O.

Old P/N	New P/N	Description	Q'ty Used	Index No.	Page
A4651100	A3181100	Front Frame	1 - 1	27	3

T. Ito, Manager  
Copier Technical Support

MODEL NAME	V/Hz	DESTINATION	CODE	SERIAL NUMBER
Ricoh DF52	115/60	USA, Canada	A422-17	
Ricoh DF52	220,240/50	Europe, etc.	A422-27	

<b>Model</b>	ARDF for F11 (Ricoh DF52)	<b>Volt/Hz</b>	<b>Date of Modification</b>	<b>Serial Number</b>
<b>Modified Article</b>	Belt Pressure Roller			
<b>Reason for Modification</b>	Parts standardization with other model			

Due to parts standardization with other model, the belt pressure roller has been changed.  
The interchangeability is O/O.

Old P/N	New P/N	Description	Q'ty	Index	Page
A4221116	A4971101	Belt Pressure Roller	1	40	3

T. Ito, Manager  
Copier Technical Support

MODEL NAME	V/Hz	DESTINATION	CODE	SERIAL NUMBER
Ricoh DF52	115/60	USA, Canada	A422-17	2331030001
Ricoh DF52	220,240/50	Europe, etc.	A422-27	233104XXXX

Model		ARDF for F11 (Ricoh DF52)						Volt/Hz	Date of Modification	Serial Number	
Modified Article		Friction Belt and Friction Roller									
Reason for Modification		To ensure separation									
Draw No.	Old Parts No.	New Parts No.	Description	A.B.C.	Q'ty Used Old → New	Inter-changeability	Part needed for replacement by new part		Parts Catalog		
				Rank			Part No.	Description	Index No.	Page	
	A4221354	A4971170	Friction belt		1 → 1	X/O			69	5	
	A4221069		Friction Roller		1 → 0				72	5	

Rank: A : Replace with new parts immediately. B : Replace with new parts at time of repair. C : Replace with new parts at time of overhaul.  
 Interchangeability:  
 (1) When old and new parts are not mutually interchangeable, use additional parts or an assembly part as indicated in "Parts needed for replacement by new part" to install the new part.  
 (2) The mark to the left of the slash indicates whether the old part can be used in the new machine, and the mark to the right indicates whether the new part can be used in the old machine. x = Not interchangeable o = Interchangeable



**DETAILS OF MODIFICATION**

To ensure the original separation, we found that it is more effective to increase the angle ( $\theta$ ) as shown. These are the modifications on production machines to change the angle from  $\theta_1$  to  $\theta_2$  :

1. The friction roller has been removed.
2. The mylar on the friction belt has been removed.
3. The dimension of the friction belt has been changed.

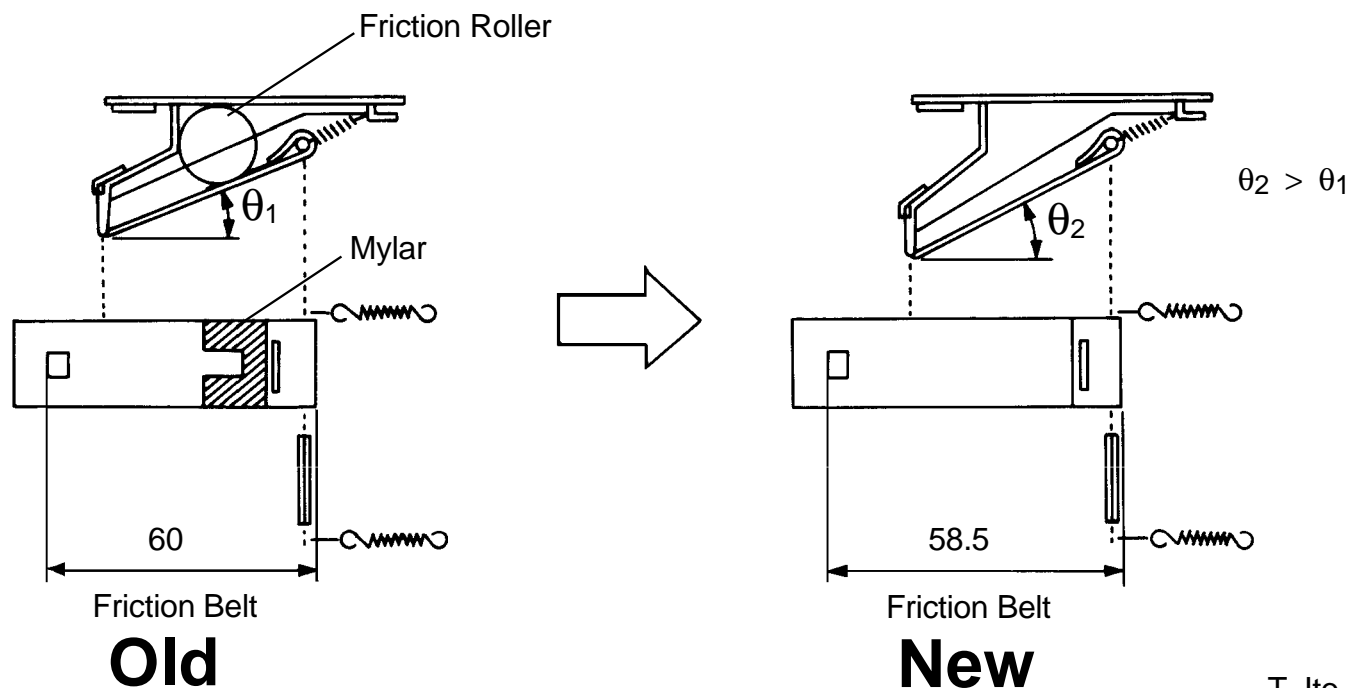

T. Ito, Manager  
Copier Technical Support

MODEL NAME	V/Hz	DESTINATION	CODE	SERIAL NUMBER
Ricoh DF52	115/60	USA, Canada	A422-17	2331050001
Ricoh DF52	220,240/50	Europe, etc.	A422-27	2331050224

<b>Model</b>	ARDF for F11 (Ricoh DF52)	<b>Volt/Hz</b>	<b>Date of Modification</b>	<b>Serial Number</b>
<b>Modified Article</b>	Harness - Pulse Generator			
<b>Reason for Modification</b>	Parts standardization with other model			

Due to parts standardization with other model, the pulse generator harness has been changed. The interchangeability is O/O. According to this change, the grounding wire has been removed.

Old P/N	New P/N	Description	Q'ty	Page	Index
A4225202	A4975202	Harness - Pulse Generator	1 → 1	5	10
A4225212		Grounding Wire	1 → 0	5	95

T. Ito, Manager  
Copier Technical Support

MODEL NAME	V/Hz	DESTINATION	CODE	SERIAL NUMBER
Ricoh DF52	115/60	USA, Canada	A422-17	2331090001
Ricoh DF52	220,240/50	Europe, etc.	A422-27	2331090081

<b>Model</b>		ARDF for F11 (Ricoh DF52)					<b>Volt/Hz</b>	<b>Date of Modification</b>	<b>Serial Number</b>	
<b>Modified Article</b>		Original Table								
<b>Reason for Modification</b>		To prevent the original table from being broken								
Draw No.	Old Parts No.	New Parts No.	Description	A.B.C.	Q'ty Used Old    New	Inter-changeability	Part needed for replacement by new part		Parts Catalog	
				Rank			Part No.	Description	Index No.	Page
	A4221323	A3181241	Original Table		1 → 1	X/O			8	3

Rank:    A : Replace with new parts immediately.                      B : Replace with new parts at time of repair.                      C : Replace with new parts at time of overhaul.

Interchangeability:

(1) When old and new parts are not mutually interchangeable, use additional parts or an assembly part as indicated in "Parts needed for replacement by new part" to install the new part.

(2) The mark to the left of the slash indicates whether the old part can be used in the new machine, and the mark to the right indicates whether the new part can be used in the old machine.    x = Not interchangeable    o = Interchangeable

**DETAILS OF MODIFICATION**

The operators often open and close the DF by holding the original table. After about 1000 ~ 3000 times, (A) of the original table will break. To prevent this problem, the material of (A) has been changed to metal.

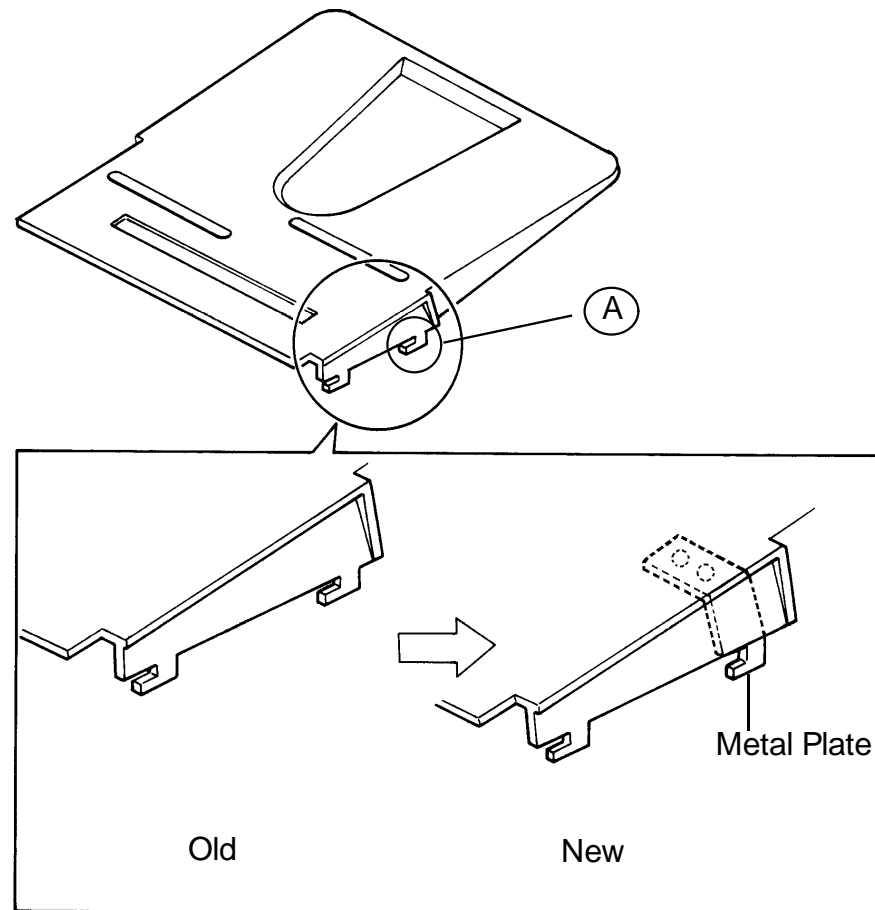

T. Ito, Manager  
Copier Technical Support

MODEL NAME	V/Hz	DESTINATION	CODE	SERIAL NUMBER
Ricoh DF52	115/60	USA, Canada	A422-17	Service Parts Only
Ricoh DF52	220,240/50	Europe, etc.	A422-27	Service Parts Only

Model		ARDF for F11 (Ricoh DF52)					Volt/Hz	Date of Modification	Serial Number	
Modified Article		Friction Belt								
Reason for Modification		To ensure the original separation								
Draw No.	Old Parts No.	New Parts No.	Description	A.B.C.	Q'ty Used Old    New	Inter-changeability	Part needed for replacement by new part		Parts Catalog	
				Rank			Part No.	Description	Index No.	Page
	A4221352	A4221360	Friction Belt Holder		1 → 1	X/X	} as a set X/O		68	5
	A4971170	A4221358	Friction Belt		1 → 1	X/X			69	5
	A4221003	A4971034	Feed Roller		1 → 1	X/X			47	5
		A4971024	Guide Mylar		0 → 1				* 97	5
									* New Index No.	

Rank:    A : Replace with new parts immediately.                      B : Replace with new parts at time of repair.                      C : Replace with new parts at time of overhaul.

Interchangeability:

(1) When old and new parts are not mutually interchangeable, use additional parts or an assembly part as indicated in "Parts needed for replacement by new part" to install the new part.

(2) The mark to the left of the slash indicates whether the old part can be used in the new machine, and the mark to the right indicates whether the new part can be used in the old machine.    x = Not interchangeable    o = Interchangeable



**DETAILS OF MODIFICATION**

To ensure the original separation, the following parts have been modified.

1. Friction Belt Holder : The configuration of the friction belt holder has been changed as shown.

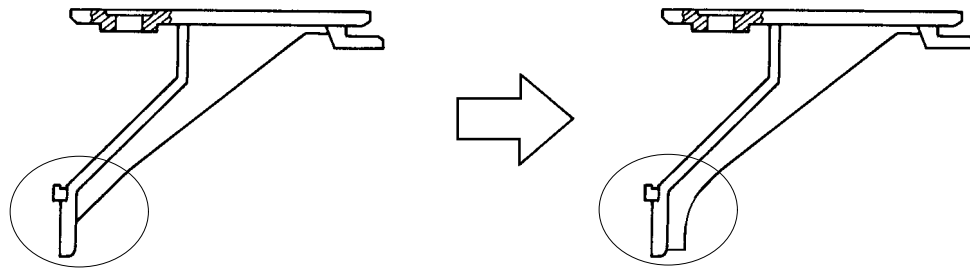

**Old**

**New**

2. Friction Belt : The configuration of the belt has been changed and a mylar has been added to improve feeding of the original.

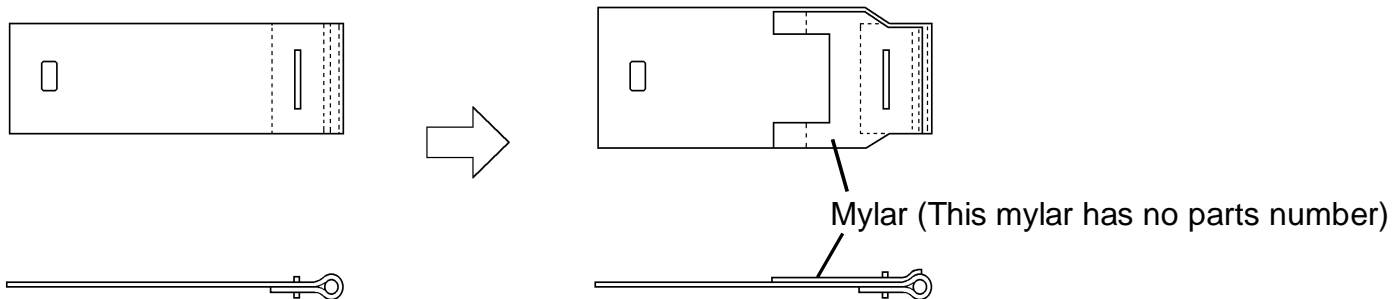

**Old**

**New**

DETAILS OF MODIFICATION

3. Original Feed Roller : To improve feeding of the original, the groove has been added to the feed roller.

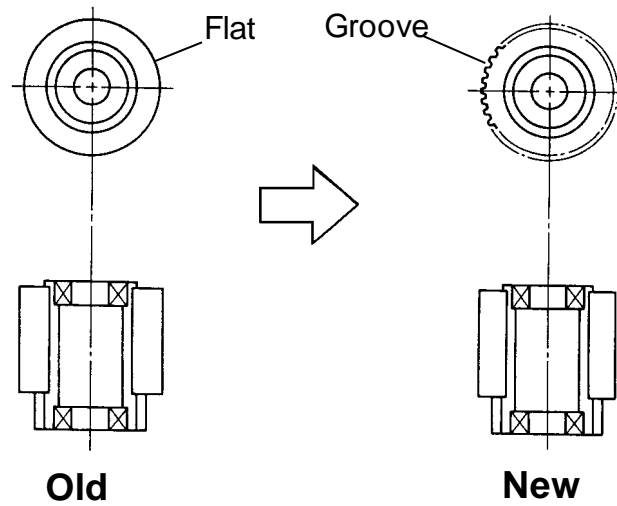

**DETAILS OF MODIFICATION**

4. Guide Mylar: A guide mylar has been added to the original guide to improve feeding of the original.

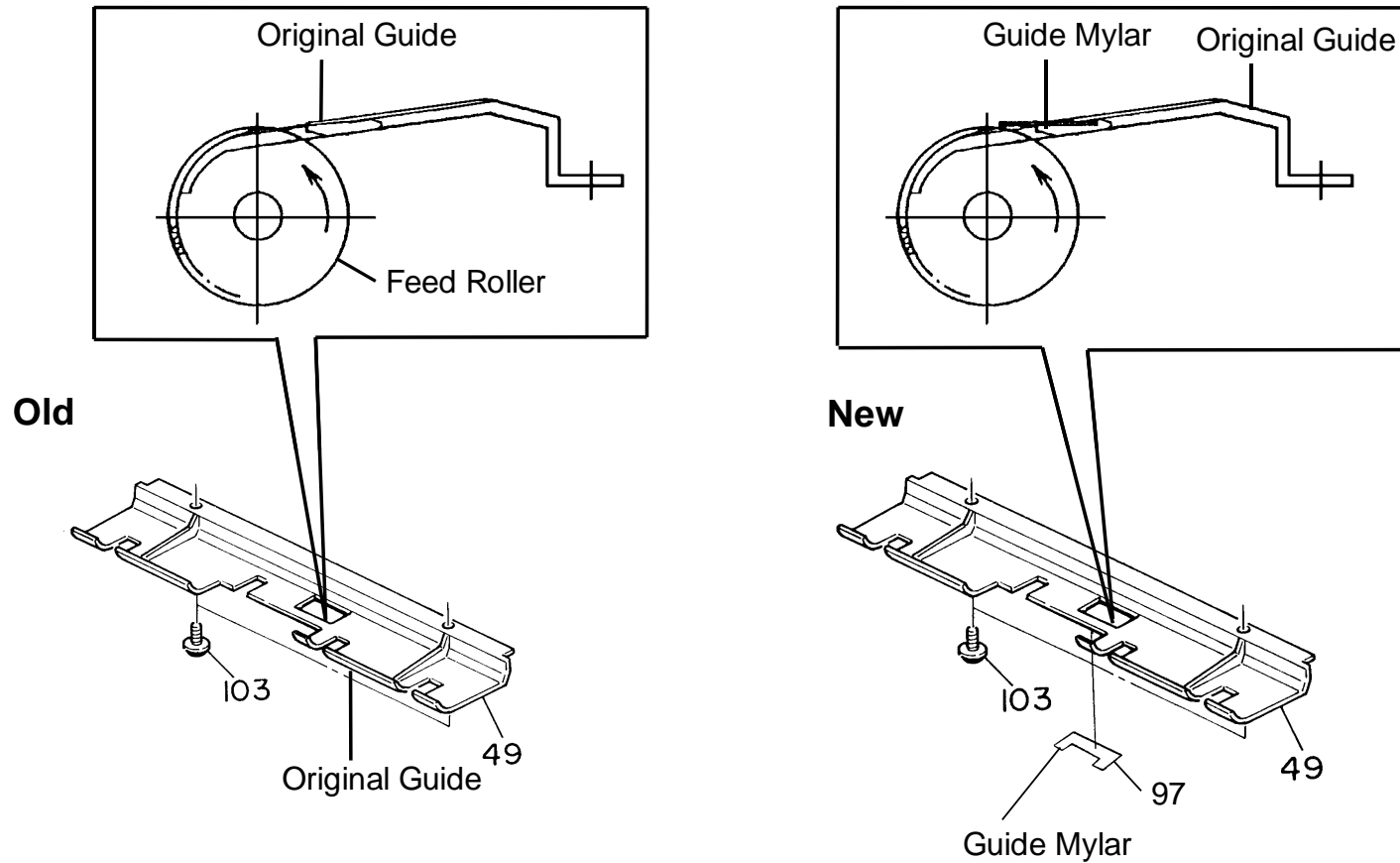

T. Ito, Manager  
Copier Technical Support

MODEL NAME	V/Hz	DESTINATION	CODE	SERIAL NUMBER
Ricoh DF52	115/60	USA, Canada	A422-17	Service Parts Only
Ricoh DF52	220,240/50	Europe, etc.	A422-27	Service Parts Only

<b>Model</b>	ARDF for F11 (Ricoh DF52)	<b>Volt/Hz</b>	<b>Date of Modification</b>	<b>Serial Number</b>
<b>Modified Article</b>	Photocoupler			
<b>Reason for Modification</b>	Due to vendor change			

Due to vendor change, the following part has been changed. The interchangeability is O/O.

Page	Index	Old P/N	New P/N	Description
9	119	14030388	└──┬──┘	Photocoupler - ON3111
9	119			14030784

T. Ito, Manager  
Copier Technical Support

MODEL NAME	V/Hz	DESTINATION	CODE	SERIAL NUMBER
Ricoh DF52	115/60	USA, Canada	A422-17	Service Parts Only
Ricoh DF52	220,240/50	Europe, etc.	A422-27	Service Parts Only

<b>Model</b>	ARDF for F11 (Ricoh DF 52)	<b>Volt/Hz</b>	<b>Date of Modification</b>	<b>Serial Number</b>
<b>Modified Article</b>	Covers			
<b>Reason for Modification</b>	Material change			

The material of the following parts have been changed.

NOTE: In this modification, the color of the following parts have been changed from black to silver.

Old P/N	New P/N	Description	Q'ty Used	Inter-changeability	Parts Catalog	
					Index No.	Page
A4221500	A4221472	Belt Drive Motor Cover	1 → 1	O/O	50	3
A4221183	A4221475	Main Board Cover	1 → 1	O/O	51	3
A4221184	A4221481	Feed-out Motor Cover	1 → 1	O/O	46	3

T. Ito, Manager  
Copier Technical Support

MODEL NAME	V/Hz	DESTINATION	CODE	SERIAL NUMBER
Ricoh DF52	115/60	USA, Canada	A422-17	Service Parts Only
Ricoh DF52	220,240/50	Europe, etc.	A422-27	Service Parts Only



<b>Model</b>	ARDF for F11 (Ricoh DF52)	<b>Volt/Hz</b>	<b>Date of Modification</b>	<b>Serial Number</b>
<b>Modified Article</b>	Pull-out Bracket			
<b>Reason for Modification</b>	To prevent original misfeed			

The DF registration sensor is activated by paper dust on the sensor pad, affecting its color. This is because, when the original roller starts rotating, the DF upper plate is warped slightly downward. The clearance between the DF registration sensor and the sensor pad is reduced. To prevent this the pull-out bracket has been modified to improve the clearance.

Old P/N	New P/N	Description	Q'ty Used	Inter-changeability	Parts Catalog	
					Index No.	Page
A4651057	A4971052	Pull-out Bracket	1 → 1	X/O	3	5

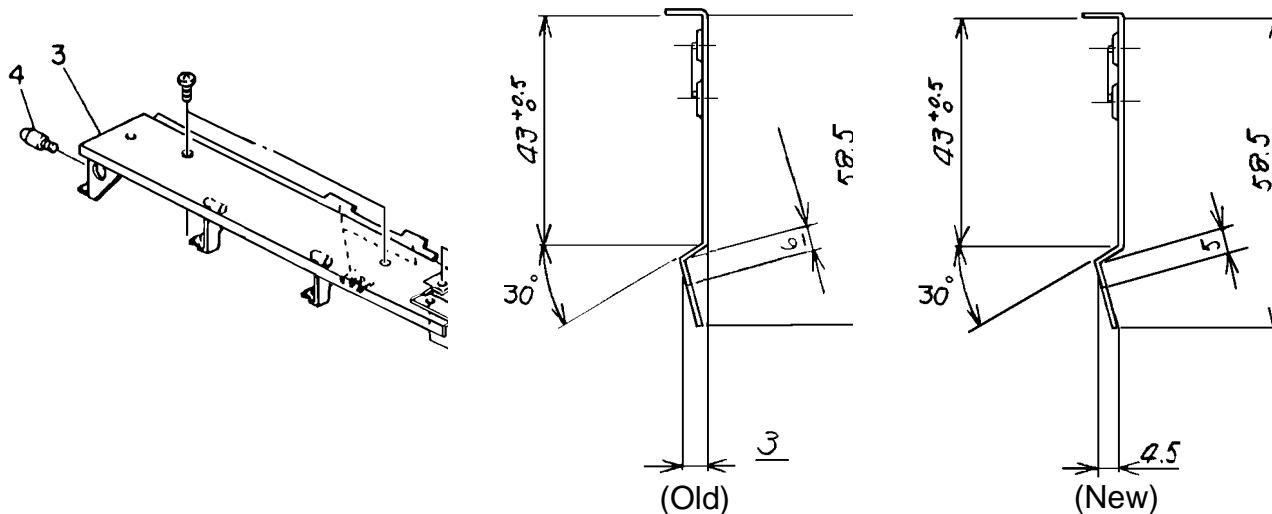

T. Ito, Manager  
Copier Technical Support

MODEL NAME	V/Hz	DESTINATION	CODE	SERIAL NUMBER
Ricoh DF52	115/60	USA, Canada	A422-17	Service Parts Only
Ricoh DF52	220,240/50	Europe, etc.	A422-27	Service Parts Only

<b>Model</b>	ARDF for F11 (Ricoh DF52)	<b>Volt/Hz</b>	<b>Date of Modification</b>	<b>Serial Number</b>
<b>Modified Article</b>	Inverter Roller			
<b>Reason for Modification</b>	Parts standardization			

To standardize the parts with other models, the following parts have been changed.

Old P/N	New P/N	Description	Q'ty Used	Inter-change-ability	Parts Catalog	
					Index No.	Page
A4221210	A4972090	Inverter Roller	1 → 1	O/O	38	7

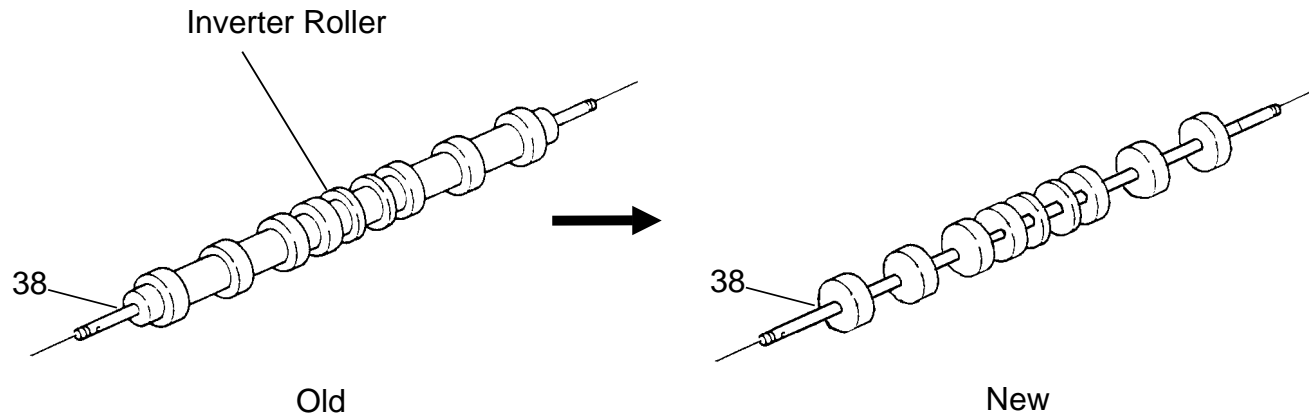

T. Ito, Manager  
Copier Technical Support

MODEL NAME	V/Hz	DESTINATION	CODE	SERIAL NUMBER
Ricoh DF52	115/60	USA, Canada	A422-17	Service Parts Only
Ricoh DF52	220,240/50	Europe, etc.	A422-27	Service Parts Only